

T-BOLTS

1/2"-13



FEATURES

- Alloy Steel
- Black Oxided
- Heat Treated to Grade 5 (125,000 psi)
- Threads Rolled to Class 2A Standard

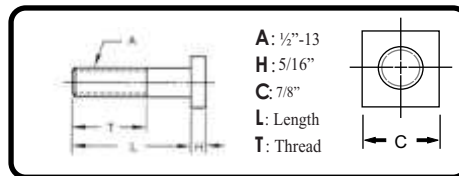

PART#	THREAD (A)	HEAD THICK (H)	HEAD (C)	LENGTH (L)	THREAD (T)
#841003	1/2"-13	5/16"	7/8"	1.500"	1.250"
#841004	1/2"-13	5/16"	7/8"	2.000"	1.750"
#841005	1/2"-13	5/16"	7/8"	2.500"	2.000"
#841006	1/2"-13	5/16"	7/8"	3.000"	2.000"
#841007	1/2"-13	5/16"	7/8"	3.500"	2.000"
#841008	1/2"-13	5/16"	7/8"	4.000"	2.000"
#841009	1/2"-13	5/16"	7/8"	4.500"	2.000"
#841012	1/2"-13	5/16"	7/8"	6.000"	2.500"

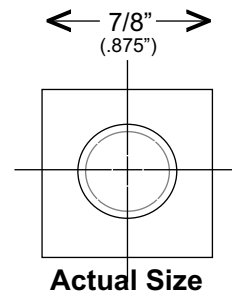

3/8"-16



FEATURES

- Alloy Steel
- Black Oxided
- Heat Treated to Grade 5 (125,000 psi)
- Threads Rolled to Class 2A Standard

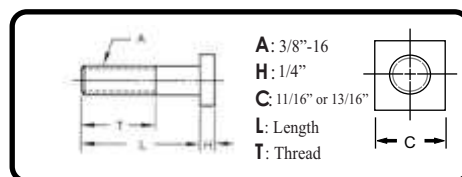

PART#	THREAD (A)	HEAD THICK (H)	HEAD (C)	LENGTH (L)	THREAD (T)
#841503	3/8"-16	1/4"	11/16"	1.500"	1.250"
#841504	3/8"-16	1/4"	11/16"	2.000"	1.750"
#841505	3/8"-16	1/4"	11/16"	2.500"	2.000"
#841506	3/8"-16	1/4"	11/16"	3.000"	2.000"
#841507	3/8"-16	1/4"	11/16"	3.500"	2.000"
#841508	3/8"-16	1/4"	11/16"	4.000"	2.000"

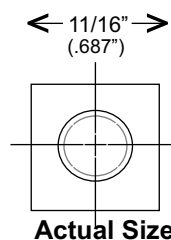

3/8"-16



FEATURES

- Alloy Steel
- Black Oxided
- Heat Treated to Grade 5 (125,000 psi)
- Threads Rolled to Class 2A Standard

New Sizes:

PART#	THREAD (A)	HEAD THICK (H)	HEAD (C)	LENGTH (L)	THREAD (T)
#TB-65	3/8"-16	1/4"	13/16"	15/16"	3/4"
#TB-70	3/8"-16	1/4"	13/16"	1 1/8"	1"
#TB-75	3/8"-16	1/4"	13/16"	1 5/8"	1 3/8"
#TB-80	3/8"-16	1/4"	13/16"	2 1/2"	2.000"

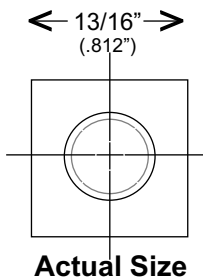

FLANGE NUTS



FEATURES

- Alloy Steel
- Black Oxided
- Heat Treated to Grade 5 (125,000 psi)
- Threads Rolled to Class 2A Standard

Large Bearing Area Ensures Full Surface Contact With Clamping Component

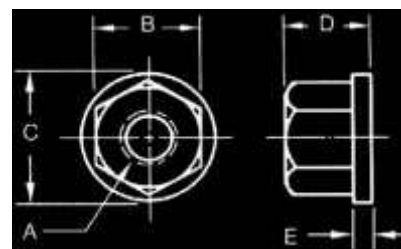

PART#	A	B	C	D	E
#825160	3/8"-16	11/16"	7/8"	1/2"	3/32"
#825165	1/2"-13	7/8"	1 1/8"	11/16"	3/16"
#825170	5/8"-11	1 1/16"	1 3/8"	13/16"	3/16"